

For Airport and Airplane Cleaning Crews: Using Personal Protective Equipment (PPE)

Take off your PPE in the following order:

1 SHOE COVERS (if worn)

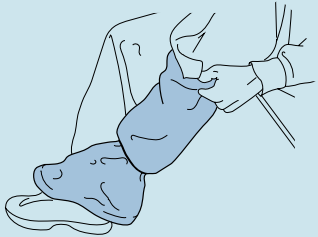

- Remove shoe covers; discard*

2 OUTER GLOVES

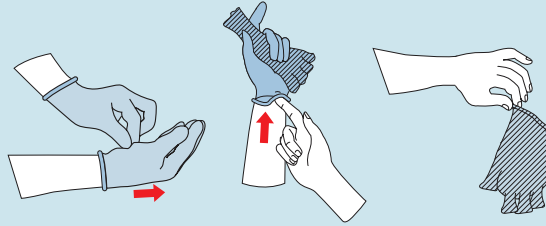

- Grasp outside of one glove with other gloved hand and peel off
- Hold removed glove in the hand that is still double gloved
- Slide a finger and thumb of the hand with single glove between the two gloves on the double-gloved hand at wrist (avoid touching the outside of outer glove with inner glove)
- Pinch and peel glove off from inside, turning glove inside out (over other glove), such that the two gloves are inside out and wrapped up inside each other in a single ball and creating a "bag" for both gloves; discard both gloves*

3 GOWN

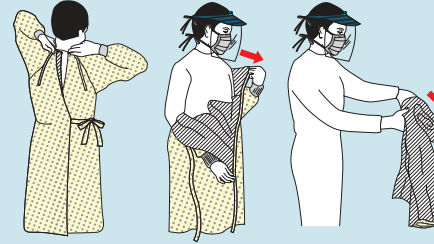

- Unfasten ties at neck and waist
- Pull gown away from neck and shoulders, touching inside of gown only
- Turn gown inside out
- Fold or roll into a bundle; discard*

4 FACE SHIELD OR GOGGLES

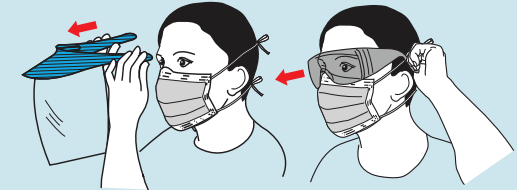

- Grasp on sides by head band or ear pieces
- Remove from face; discard*

5 FACE MASK

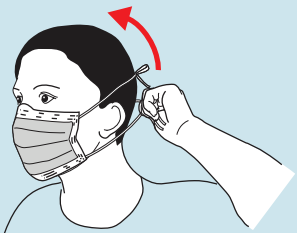

- Untie the bottom and then the top tie; if mask has elastic bands, remove mask by pulling up bottom band first
- Remove from face without touching skin or clothes; discard*

6 INNER GLOVES

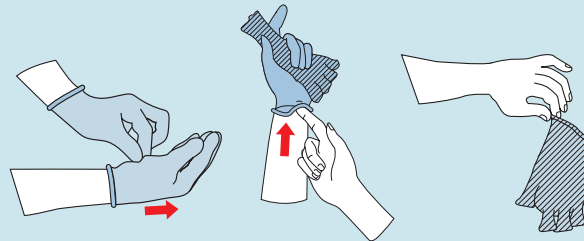

- Grasp outside of glove with other gloved hand and peel off
- Hold removed glove in the hand that is still gloved
- Slide ungloved clean finger and thumb under remaining glove at wrist
- Pinch and peel the second glove off from inside, creating a "bag" for both gloves; discard*

7 WASH HANDS

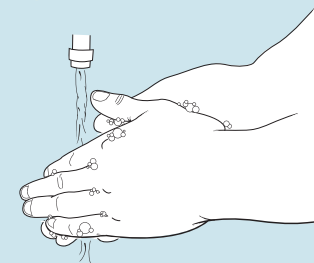

- Wash hands with soap and water immediately after removing PPE
- Use alcohol-based hand rub if soap and water are unavailable

*After removing PPE, place contaminated items in previously identified plastic bags for disposal. If not already labeled, attach a BIOHAZARD warning label to or otherwise mark the outside of the bag. If contaminated items are not dry, they should be placed in a leak-proof bag and double-bagged. If you don't know where bags containing contaminated items should be thrown away, consult your supervisor.